



KONICA MINOLTA

bizhub C3350i

Color A4 multifunctional

**bizhub
i-SERIES IS
SMARTER
WORKING**
RETHINK IT



Giving Shape to Ideas

CUSTOMER BENEFITS



Intuitive operability
Operate the bizhub like a smartphone or tablet with fully customised user interface



Mobile connectivity
Print anytime from anywhere with Konica Minolta's innovative mobile technologies



Security
Secure network integration, data encryption, hard drive overwrite, and advanced user authentication



Application ecosystem
Enhanced efficiency thanks to Konica Minolta's extensive applications portfolio



Services
Efficient printer fleet management, including automatic consumables delivery, pro-active maintenance and remote setup



Sustainability
Numerous eco features reduce energy consumption and costs

OPTIONS

1 ENHANCED FEATURES

PDF enhancements
LK-102v3

OCR text recognition
LK-105v4

Barcode fonts
LK-106

Unicod fonts
LK-107

OCR A and B fonts
LK-108

Document converter pack
LK-110v2

ThinPrint® client
LK-111

Serverless pull printing
LK-114

Trusted Platform Module activation
LK-115v2

Antivirus
LK-116

2 CONNECTIVITY

Fax board
FK-517

Wireless LAN
UK-221

USB I/F kit
EK-P08

USB I/F kit
EK-P09

I/F cable for CSRC modem
EK-P11

Biometric authentication
AU-102

ID card reader

Mount kit
MK-P08

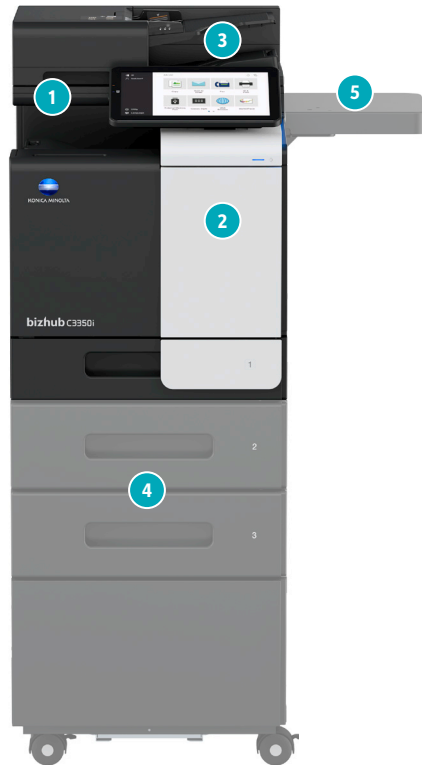

LEGEND

- Mandatory option
- Option
- This option can only be installed with the respective option above it

3 OTHERS

Working table
WT-P03

Double feed detection kit
UK-P19

10-Key pad
KP-102

Keyboard holder
KH-P02

Air cleaning unit
CU-202

Mount kit
MK-P09

4 MEDIA INPUT

Paper tray
PF-P20

Height adjustment unit
PF-P22

Copy desk
DK-P04x

5 MEDIA OUTPUT

Off-line stapler
FS-P04

FINISHING FUNCTIONALITIES



Duplex



Corner stapling (offline)

DESCRIPTIONS

ENHANCED FEATURES

LK-102v3 PDF enhancements	PDF/A (1b); PDF encryption; digital signature
LK-105v4 OCR text recognition	Searchable PDF and PPTX
LK-106 Barcode fonts	Supports native barcode printing
LK-107 Unicode fonts	Supports native Unicode printing
LK-108 OCR A and B fonts	Supports native OCR A and B font printing
LK-110v2 Document converter pack	Generates various file formats incl. DOCX; XLSX and PDF/A
LK-111 ThinPrint® client	Print data compression for reduced network impact
LK-114 Serverless pull printing	Secure and Follow Me printing solution requiring no server application
LK-115v2 TPM activation	Trusted Platform Module for protection of data encryption and decryption
LK-116 Antivirus	Bitdefender® Antivirus provides real time scanning of all incoming and outgoing data

CONNECTIVITY

FK-517 Fax board	Super G3 fax, digital fax functionality
UK-221 Wireless LAN	Wireless LAN and wireless LAN Access Point Mode
EK-P08 USB I/F kit	USB keyboard connection
EK-P09 USB I/F kit	USB keyboard connection; Bluetooth
EK-P11 I/F cable for CSRC modem	GPRS modem connection for CSRC
AU-102 Biometric authentication	Finger vein scanner
ID card reader	Various ID card technologies
MK-P08 Mount kit	Installation kit for ID card reader

OTHERS

WT-P03 Working table	Authentication device placement
UK-P19 Double feed detection kit	Multi-feed detector to reduce errors and paper jams
KP-102 10-Key pad	For use instead of touchscreen
KH-P02 Keyboard holder	To place USB keyboard
CU-202 Air cleaning unit	Improving indoor air quality by reduced emissions
MK-P09 Mount kit	Installation kit for Air cleaning unit

MEDIA INPUT

PF-P20 Paper tray	500 sheets, A4, 60-90 g/m ²
PF-P22 Height adjustment unit	To achieve comfortable height for operation
DK-P04x Copier desk	Provides storage space for print media and other materials

MEDIA OUTPUT

FS-P04 Off-line stapler	20-sheet corner stapling
-------------------------	--------------------------

TECHNICAL SPECIFICATIONS

SYSTEM SPECIFICATIONS

Panel size/resolution	10.1" / 1024 x 600
System memory (standard/max)	5,120 MB
System hard drive	256 GB SSD (standard)
Interface	10/100/1,000-Base-T Ethernet; USB 2.0; Wi-Fi 802.11 b/g/n (optional)
Network protocols	TCP/IP (IPv4/IPv6); SMB; LPD; IPP; SNMP; HTTP(S); AppleTalk; Bonjour
Automatic document feeder (standard)	Up to 80 originals; A5-A4; 50-128 g/m ² ; Dualscan ADF
Paper input capacity (standard/max)	600 sheets / 1,600 sheets
Paper tray input (standard)	1x 500 sheets; A6-A4; custom sizes; 60-210 g/m ²
Paper tray input (optional)	1x 500 sheets; A4; 60-90 g/m ² 1x 500 sheets; A4; 60-90 g/m ²
Manual bypass	100 sheets; A6-A4; Custom sizes; 60-210 g/m ²
Automatic duplexing	A4; 60-210 g/m ²
Finishing modes (optional)	Group; Sort; Staple (offline)
Output capacity (standard)	Max. 250 sheets
Copy/print volume (monthly)	Rec. 6,500 pages; Max. ¹ 96,000 pages
Toner lifetime	Black up to 13,000 pages CMY up to 9,000 pages
Imaging unit lifetime	Black up to 159,000 pages (imaging unit) CMY up to 55,000 pages (imaging unit)
Power consumption	220-240 V / 50/60 Hz; Less than 1.45 kW
System dimension (W x D x H)	420 x 528 x 572 mm (without options)
System weight	Approx. 39.0 kg (without options)

PRINTER SPECIFICATIONS

Print resolution	1,800 (equivalent) x 600 dpi; 1200 x 1200 dpi
Page description language	PCL 6 (XL3.0); PCL 5c; PostScript 3 (CPSI 3016); XPS
Operating System	Windows 7 (32/64); Windows 8/8.1 (32/64); Windows 10 (32/64); Windows Server 2008 (32/64); Windows Server 2008 R2; Windows Server 2012; Windows Server 2012 R2; Windows Server 2016; Windows Server 2019; Macintosh OS X 10.10 or later; Unix; Linux; Citrix
Printer fonts	80 PCL Latin; 137 PostScript 3 Emulation Latin
Mobile printing	AirPrint (iOS); Mopria (Android); Konica Minolta Mobile Print (iOS/Android/Windows 10 Mobile); Mobile Authentication and Pairing (iOS/Android) Optional: Google Cloud Print; WiFi Direct

SCANNER SPECIFICATIONS

Scan speed (mono/colour)	Up to 45/45 ipm in simplex Up to 90/90 ipm in duplex
Scan modes	Scan-to-eMail (Scan-to-Me); Scan-to-SMB (Scan-to-Home); Scan-to-FTP; Scan-to-Box; Scan-to-USB; Scan-to-WebDAV; Scan-to-URL; TWAIN scan
File formats	JPEG; TIFF; PDF; Compact PDF; Encrypted PDF; XPS; Compact XPS; PPTX // Optional: Searchable PDF; PDF/A 1a and 1b; Searchable DOCX/PPTX/XLSX
Scan destinations	2,100 (single + group); LDAP support

COPIER SPECIFICATIONS

Imaging technology	Laser
Toner technology	Simitri® HD polymerised toner
Copy/print speed A4 (mono/colour)	Up to 33/33 ppm
Autoduplex Speed A4 (mono/colour)	Up to 33/33 ppm
1 st copy out time A4	5.6/6.3 sec.
Warm-up time	Approx. 13 sec. in mono; 15 sec. in color ²
Copy resolution	600 x 600 dpi
Gradation	256 gradations
Multicopy	1–9,999
Original format	A6–A4; Custom sizes
Magnification	25–400% in 0.1% steps; Auto-zooming

FAX SPECIFICATIONS

Fax standard	Super G3 (optional)
Fax transmission	Analogue; i-Fax; Colour i-Fax; IP-Fax
Fax resolution	Up to 600 x 600 dpi
Fax compression	MH; MR; MMR; JBIG
Fax modem	Up to 33.6 Kbps
Fax destinations	2,100 (single + group)

USER BOX SPECIFICATIONS

Storable documents	Up to 3,000 documents or 10,000 pages
Type of user boxes	Public; Personal (with password or authentication); Group (with authentication)
Type of system boxes	Secure print; Encrypted PDF print; Fax receipt; Fax polling

SYSTEM FEATURES

Security Functions (standard)	ISO 15408 HCD-PP Common Criteria (in evaluation); IP filtering and port blocking; SSL2; SSL3 and TLS1.0/1.1/1.2 network communication; IPsec support; IEEE 802.1x support; User authentication; Authentication log; Secure print; Kerberos; Hard drive overwrite; Hard drive data encryption (AES 256); Confidential fax receipt; Print user data encryption
Security Functions (optional)	Antivirus realtime scanning (Bitdefender®)
Accounting (standard)	Up to 1,000 user accounts; Active Directory support (user name + password + e-mail + smb folder); User function access definition
Accounting Functions (optional)	Biometric authentication (finger vein scanner); ID card authentication (ID card reader); Authentication by mobile device (Android/iOS)
Software	Net Care Device Manager; Data Administrator; Box Operator; Web Connection; Print Status Notifier; Driver Packaging Utility; Log Management Utility

¹ If the maximum volume is reached within a period of one year, then a maintenance cycle must be performed

² Warm-up time may vary depending on the operating environment and usage

- All specifications refer to A4-size paper of 80 g/m² quality.
- The support and availability of the listed specifications and functionalities varies depending on operating systems, applications and network protocols as well as network and system configurations.
- The stated life expectancy of each consumable is based on specific operating conditions such as page coverage for a particular page size (5% coverage of A4). The actual life of each consumable will vary depending on use and other printing variables including page coverage, page size, media type, continuous or intermittent printing, ambient temperature and humidity.
- Some of the product illustrations contain optional accessories.
- Specifications and accessories are based on the information available at the time of printing and are subject to change without notice.
- Konica Minolta does not warrant that any specifications mentioned will be error-free.
- All brand and product names may be registered trademarks or trademarks of their respective holders and are hereby acknowledged.

Simitri HD
High Definition Polymerised Toner

SAP® Printer Vendor Solution

CORTADO

